

## Dimensions

**Mounting options** DIN rail (35 mm)

**Dimensions** 92.5 / 72 / 62 mm

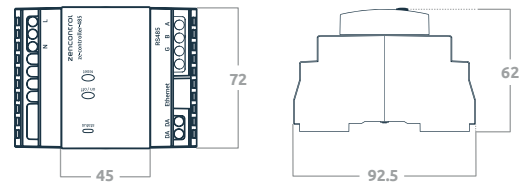

## System overview

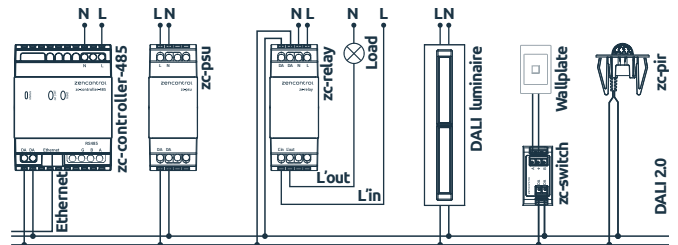

## Product range

Order code	Description
<b>zc-controller-485</b>	DALI Application controller and Ethernet DALI gateway with S-485 output to suit motor control

## Specifications

<b>Supply voltage</b>	230 V ~ 50 Hz
<b>Control system</b>	DALI-2
<b>DALI line current</b>	2 mA
<b>Ethernet</b>	10/100 Ethernet port
<b>RS-485 network type</b>	Half duplex
<b>Wiring</b>	1 - 4 mm <sup>2</sup> Strip 6 - 7 mm
<b>Operating temperature</b>	0 to 45°C
<b>Material</b>	PC
<b>Classification</b>	Class II
<b>Ingress protection</b>	IP20

## Installation

Remove the product from the box and inspect it for any damage. If you believe the product to be damaged or otherwise unsound, **do not** install the product. Please pack it back into its box and return it to the place of purchase for replacement.

If the product is satisfactory, proceed with the installation:

- 1 Ensure safety warnings are adhered to.
- 2 Mount the DALI application controller on DIN rail inside a mains rated enclosure as shown in **fig 1**. To remove from DIN rail, release the clip mechanism with a flat blade screw driver, as per **fig 2**.
- 3 Wire the DALI application controller as per **fig 3**.

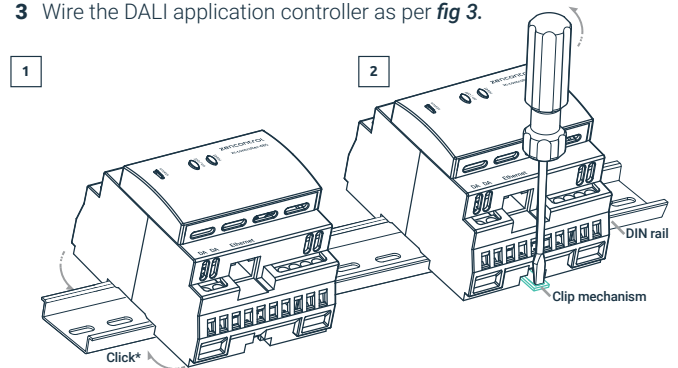

## Wiring diagram

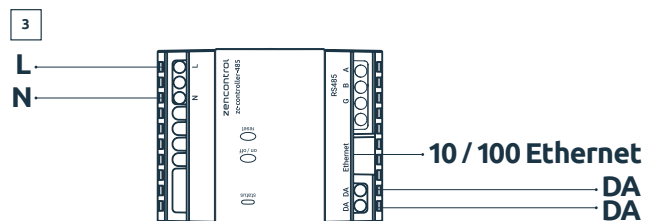

Wire preparation

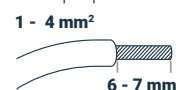

## Safety information

- This product must only be installed by a licensed electrician.
- Before commencing installation turn off and isolate the electrical supply.
- There are no user serviceable parts, attempting to service any part of the product will void the warranty
- DALI is not SELV and as such should be treated as LV.
- As the installer, it is your responsibility to ensure you comply to all relevant building and safety codes. Refer to application standards for the relevant rules.
- When the installation is complete, leave this manual with the building's owner for future reference.

## Configuration

- Requires external DALI power supply such as **zc-psu**
- Each motor consumes an additional DALI address i.e. with 12 blind motors connected only 52 ECGs can be connected.
- A termination resistor needs to be placed at each end of the RS-485 line for reliable operation. The resistor should be matched to the impedance of the cable, typically 120 Ohm.
- Blind motors appear on controller as DALI devices and can be configured in the same manner.
- Before operation motor limits must be set using the *Somfy Digital Network™ (SDN) RS485 Motor Limit Setting & Address Reader Tool*.

## Status LEDs

LED	State	Meaning
Status	Green - On	Unit is powered
On / off & reset	Green - Alternating flash	Bootload in process
On / off & reset	Green - Synchronised flash	Start up in process
On / off	Green - Flash / flicker	DALI activity
On / off	Red - Flash	DALI failure

**Note:** DALI failure indicates the DALI line has a short, is overloaded, is disconnected or is not powered

## Button actions

Button	Action	Function
On / off	Short press	Toggles lights (max / off)
On / off	5 second press	Toggles identify function
Reset	1 - 2 seconds press	Force Cloud reconnect
Reset	3 - 10 second press	Reboot
Reset	11 - 15 second press	Factory reset

## Indicators

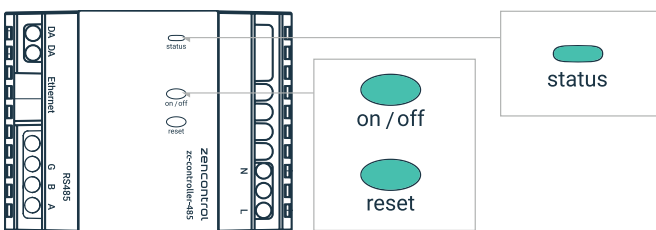

## Accessories range

Order code	Description
<b>zc-psu</b>	DALI-2 power supply, DIN mount

## Notice



For more information on compliant software see our website [zencontrol.com](https://zencontrol.com)