

Dimensions

Mounting options Inbuilt

Dimensions 80 / 16 / 30 mm

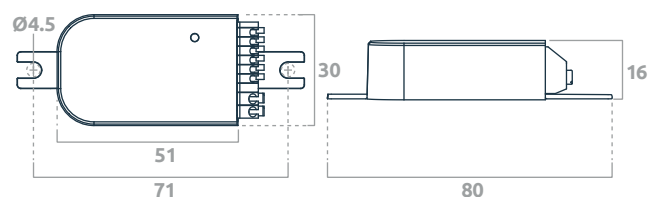

Wireless system overview

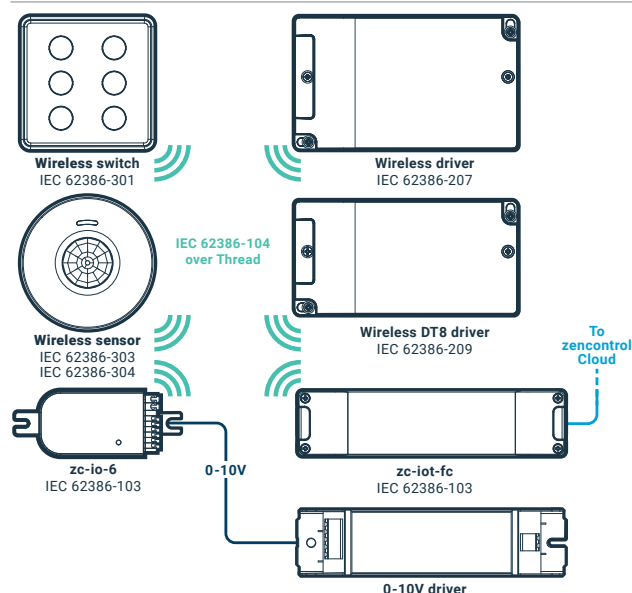

Installation

Remove the product from the box and inspect it for any damage. If you believe the product to be damaged or otherwise unsound, **do not** install the product. Please pack it back into its box and return it to the place of purchase for replacement.

If the product is satisfactory, proceed with the installation:

- 1 Ensure safety warnings are adhered to.
- 2 Wire according to relevant wiring diagram.
- 3 Optional: Break off back tab, and align front tab to case, per **fig 2**.

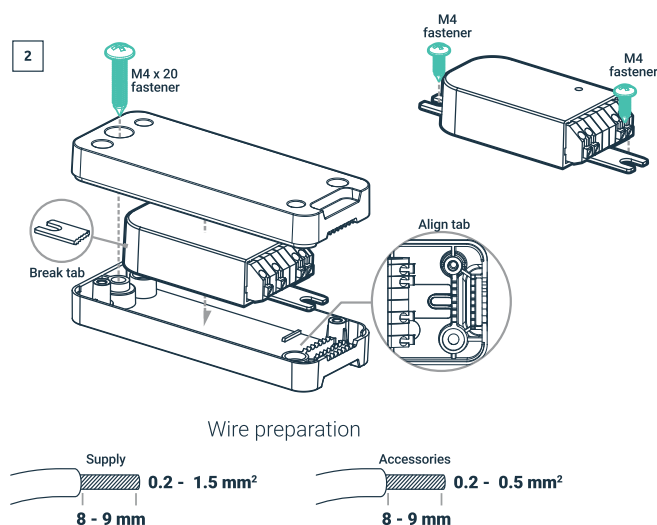

Product range

Order code	Description
zc-io-6	Smart I/O interface, 6 channel

Specifications

Supply voltage	12 - 24 Vdc
Supply current	<0.7A
Control system	IEC62386-104 over Thread
Wiring	0.2 - 1.5 mm ² (supply) 0.2 - 0.5 mm ² (accessories) Strip 8 - 9 mm
Operating temperature	0 to 60°C
Material	PC
Mounting	Inbuilt
Ingress protection	IP20
Output voltage (0-10)	0-10Vdc
Input Voltage (0-10)	0-24Vdc
Output current (0-10)	<2mA max
Output voltage (OUT 1, OUT 2)	Supply voltage (12 - 24Vdc)
Output current (OUT 1, OUT 2)	200mA max / channel
Input voltage (IN 1, IN 2, IN 3)	24V max
Classification	III

Safety information

- Before commencing installation turn off and isolate the electrical supply.
- There are no user serviceable parts, attempting to service any part of the product will void the warranty
- As the installer, it is your responsibility to ensure you comply to all relevant building and safety codes. Refer to applicable standards for the relevant rules.
- When the installation is complete, leave this manual with the building's owner for future reference.

Wiring diagrams

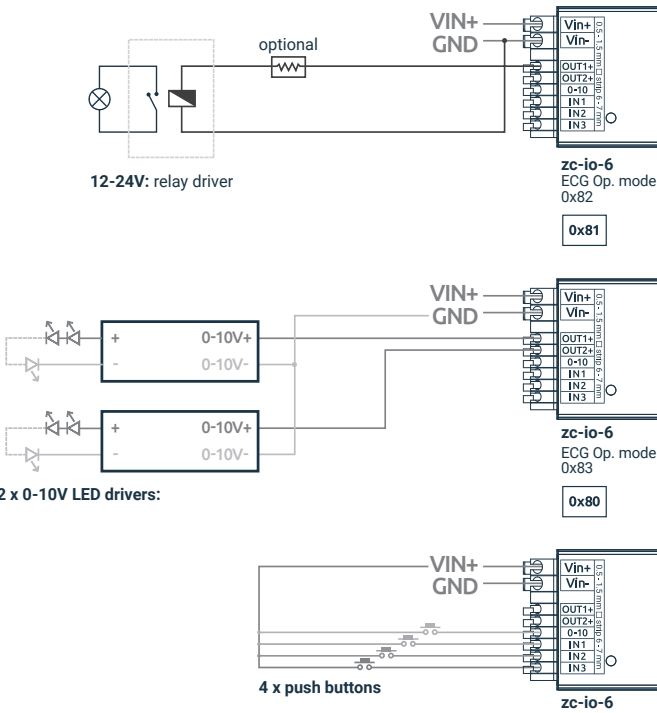

ECG configuration

0x00	DT5 0-10V output
0x80	
0x81	DT7 switching function (open collector)

For more information on ECD operation mode and instance type configuration see our website [zencontrol.com](https://support.zencontrol.com)

Instance configuration

Each input supports the following configurations with a logic high as active.

301	Push button
302	Absolute input binary
303	Occupancy
306	Voltage sensor

Both the 0-10 input and inputs 1-3 suport additional configuration. See support.zencontrol.com for details and wiring diagrams.

Terminal configurations

Product terminal	Default config.	Optional config.1	Optional config.2	Optional config.3
OUT1+	0-10V output	DC output	-	-
OUT2+	0-10V output	DC output	-	-
0-10	Absolute input	General purpose sensor	Occupancy sensor	Push button
IN1	Push button	General purpose sensor	Occupancy sensor	Absolute input
IN2	Push button	General purpose sensor	Occupancy sensor	Absolute input
IN3	Push button	General purpose sensor	Occupancy sensor	Absolute input

Binary input configuration

ECD operating mode	0-10	IN1	IN2	IN3
Standard	User configured	User configured	User configured	User configured
2bit binary input	User configured	User configured	MSB	LSB
3bit binary input	User configured	MSB	2nd bit	LSB
4bit binary input	MSB	3rd bit	2nd bit	LSB

Binary input configuration example

4bit binary input						Result
		0-10 (MSB)	IN1 (3rd bit)	IN2 (2nd bit)	IN3 (LSB)	-
Example 1	Pin state	High	Low	High	Low	N/A
	Binary value	8	0	2	0	Event 10
Example 2	Pin state	Low	High	High	High	N/A
	Binary value	0	3	2	1	Event 6

Accessories range

Order code	Description
zc-fm-kit	Field mount kit

Notice



For more information on compliant software see our website zencontrol.com